

SECTION B - B

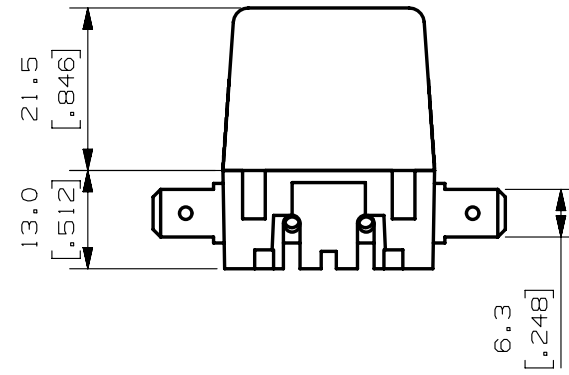
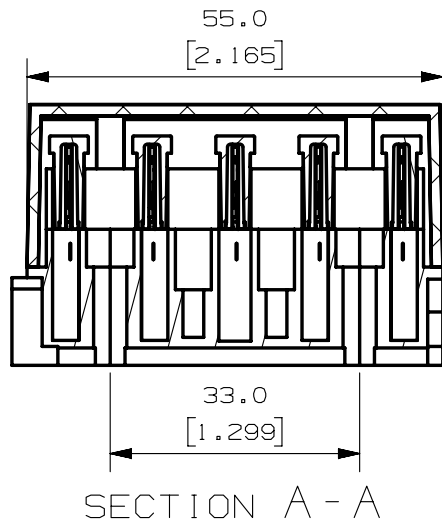
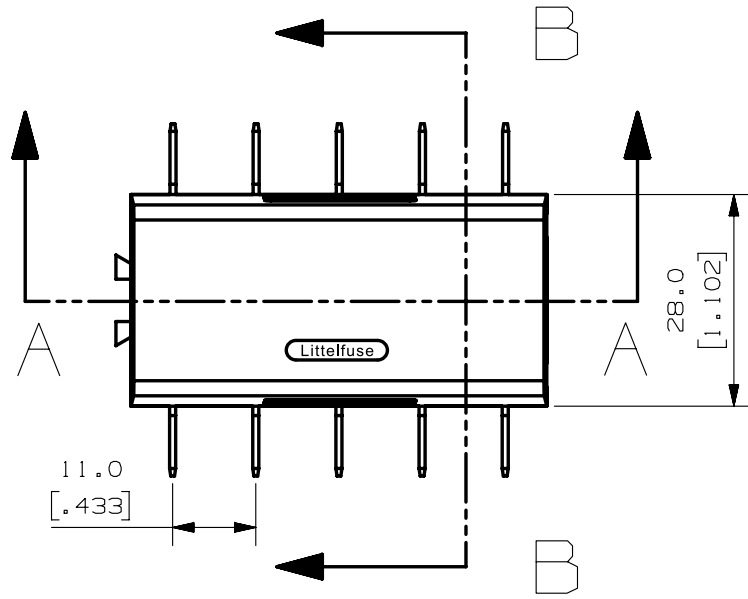

METRIC  
ASSEMBLY

- NOTES:  
 1. MATERIALS:  
 COVER: CRYSTAL-CLAEER POLYCARBONATE  
 BODY: BLACK POLYAMIDE, GLASS FIBER REINFORCED  
 CONTACT SECURING: WHITE POLYAMIDE, GLASS FIBER REINFORCED  
 CONTACTS: TIN PLATED BRASS, PLATING THICKNESS 8-10u

NO	COMPONENT NO	DESCRIPTION	QTY/M	U/M
BILL OF MATERIAL				
		UNLESS OTHERWISE SPECIFIED, DIMENSIONS ARE IN MILLIMETERS. DIMENSIONS IN BRACKETS [ ] ARE INCHES		
		UNLESS OTHERWISE SPECIFIED, DIMENSIONS DO NOT INCLUDE PLATING.		
⊙		DENOTES CRITICAL CHARACTERISTICS.		
CPK		DENOTES CPK DIMENSIONS, -MINIMUM CPK VALUE		
ST		DENOTES A CHARACTERISTIC THAT PROVIDES AN INDICATION OF PROCESS PERFORMANCE. PROCEDURE FOR MEASUREMENT AND TRACKING TO BE DEFINED IN LITTELFUSE INSPECTION INSTRUCTIONS		
CP		DENOTES CP DIMENSIONS, -MINIMUM CP VALUE MUST BE WITHIN THE DIMENSIONAL LIMITATIONS SHOWN ON DRAWING AND INITIALLY LOCATED TO ALLOW FOR MAXIMUM TOOL LIFE		

LTR	DATE	REVISION	CHK	APD
A	5/Jan/16	515377GCA-RELEASE FYUE		

MATL SPEC	REFER TO NOTES
FINISH	REFER TO NOTES
DRW	DATE 8/16/13
FYUE	SCALE 1:1
CHK	DATE
APPD	DATE
	FINISH GOOD WT
	GRAMS/PIECE
TOLERANCES UNLESS OTHERWISE SPECIFIED (REF. ISO 2768-FH)	
DIMENSION	UP TO 0.5
	0.5 - 3
	3 - 6
	6 - 30
	30 - 120
	120 - 400
TOLERANCE	+0.1
	+0.2
	+0.3
	+0.5
3RD ANGLE PROJECTION	
TITLE ATO BLOCK 5 POSITIONS, HORIZONTAL CONTACTS	
Littelfuse	
LIPA CITY, BATANGAS, PHILIPPINES	
REVISION	DRWG. NO.
A	03500417Z
OUTLINE	