

<u>Revision Control Record</u>			
Rev.	Description of Change	ECN No.	Date
A	INITIAL RELEASE	03450	10/15/03

NOTES:

1. SOCKET FOR HIGH POWER RELAY SERIES (70A @ 12V & 35A @ 24V).
2. MATERIAL: 6/6 NYLON 30GR, BLACK.
3. DIMENSIONS ARE REFERENCE ONLY.
4. FITS RA RELAY AND NOT RC (FORM C).
5. SOCKETS CAPABLE OF BEING GANGED TOGETHER BY USING DOVE-TAIL TYPE JOINTS.

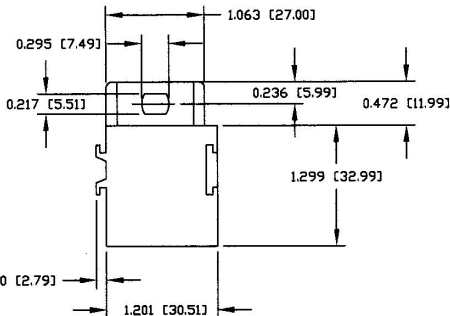

Tolerances - Unless otherwise specifically noted, the following are default tolerances:
 * 2-place Decimal Dimensions
 * 3-place Decimal Dimensions
 * Angular Dimensions ± 1.5 Deg.
 * Metric: Refer to equivalent English Dimension Tolerance
 *** NOTE: All tolerances are Non-Cumulative. ***

Dimensional Units - All dimensions are expressed in inches except those shown in brackets (xxx) are expressed in millimeters.

REF - MAN ASSEMBLY - Non-Tolerance Reference Dimension, shown for clarification purposes only.

PROPRIETARY INFORMATION - This Engineering Drawing, and the information contained herein, is proprietary to Cole Hersee Company and may not be disclosed, re-released, or in any other way transmitted or communicated to any other party without the express written consent of an authorized representative of Cole Hersee Company.

DESIGN CONTROL - It is the responsibility of the individual using/referencing this drawing to ensure that the most design-relevant level agrees with the revision level of the Controlled Document (Master Drawing). This is a NON-CONTROLLED DOCUMENT unless otherwise specifically noted.

DO NOT SCALE - Dimensional variation may occur during printing/reproduction.

Special Characteristics:



Critical Characteristic, relating to Safety and/or Regulatory Compliance



Significant Characteristic relating to Process Control (SPC)



Key Characteristic relating to Form - FE - Functions as defined by Cole Hersee Company and/or the Customer

(Note that the identification of any Characteristics as being "Special" does not alter the requirement that ALL specified dimensions & tolerances must be met.)



Cole Hersee Co.

20 Old Colony Ave., South Boston, MA, 02127
 Phone: 617-268-2100 Web: www.colehersee.com

Description: SOCKET FOR RELAYS, HIGH POWER

Drawing / Part No.: 99025

Current Rev.: A

Used On or Ref.: RELAYS

Scale: 1:1

Drawn By: JT

Date Drawn: 9/9/03

Responsible Engineer: JT

Pg. 1 of 1