

COLE-HERSEE CO.

8166

PART NO.	KNOB NO. (COLOR)	WORDING	COLOR	STYLE
8166-13	8150-B1 (BLACK)	SWITCH	WHITE	I
8166-12	81367 (BULL BLACK)	NONE	—	—
8166-11	8150-B4 (YELLOW)	NONE	—	—
8166-10	-B3 (TAN)	NONE	—	—
8166-09	-B1 (BLACK)	WIPER	WHITE	I
8166-08	-B1 (BLACK)	PANEL LIGHTS	WHITE	II
8166-07	-B1 (BLACK)	PANEL LAMPS	WHITE	II
8166-06	-B1 (BLACK)	LIGHTS	WHITE	I
8166-05	-B1 (BLACK)	HEATER	WHITE	I
8166-04	-B1 (BLACK)	FAN	WHITE	I
8166-03	-B1 (BLACK)	DOME LIGHT	WHITE	II
8166-02	-B2 (IVORY)	NONE	—	—
8166-01	8150-B1 (BLACK)	NONE	—	—

8166-KNOB  
SEE CHART

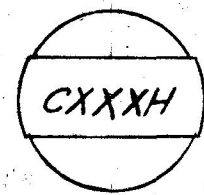

STYLE I

8-32 TAPPED HOLE  
1/32 X 45° CHAMFER

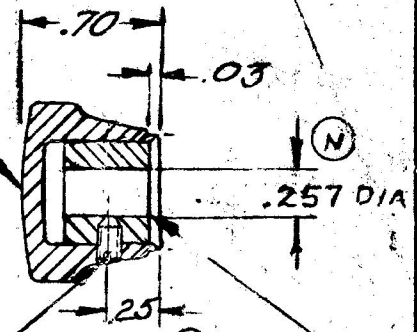

80264 INSERT  
ALUM.-8200  
SET SCR STEEL  
8-32

IMPRINTING  
(SEE CHART)

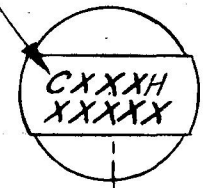

STYLE II (STYLE I EXCEPT IMPRINTING)

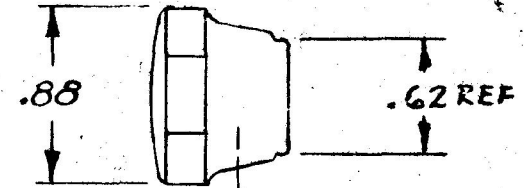

STYLE III (STYLE II EXCEPT IMPRINTING)

SEE SEPARATE DRAWING  
FOR IMPRINTING

DO NOT SCALE

LET	WAS	DATE	BY	LET	WAS	DATE	BY	MATERIAL	DRAWN	CHECKED	APPRVD.	SCALE	DATE DRAWN
				N	ADD 18094	4-6-73	RF	NOTED	M.W.	REB		2X	9-1-50
				M	COLOR ADDED TO KNOB COL.	3-15-73	R.B.	FINISH					DATE BLUEPRINT
				L	COLOR ADDED TO KNOB COL.	2-27-73	R.B.	NOTED					
				K	8166-20 17975	1-12-73	CB	TOLERANCES					
				J	REV. 17866	9-18-72	B	FRACTIONAL ±					
								DECIMAL ±					

COLE-HERSEE COMPANY  
BOSTON, MASS. 02127, U.S.A.

KNOB S.A.

8166

SPAULDING CO.